

Measure Your Existing Space

- A) Start with the first wall on the left and work to your right around the room. First, measure the overall length of each wall in your kitchen. Use grid paper to record all your measurements.
- B) Indicate all breaks in walls (windows, doors, closets) by measuring from the corner to the outside edge of the molding. Don't forget to indicate any permanent appliances, air vents, offsets, etc.
- C) Measure to centerline of plumbing, ducting and outlets. Remember, plumbing and outlets may be moved to accommodate a design.

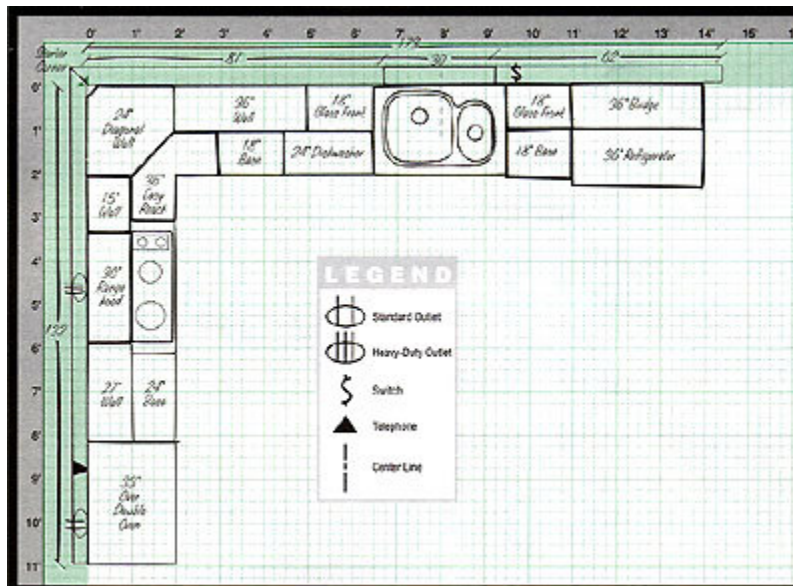

Create Your Floor Plan

Using your kitchen measurements, start sketching your cabinets. Start in the corner of your grid paper and work out. Note the location of your electrical outlets, plumbing fixtures and air ducts. You may be able to move major appliances several inches either way to accommodate a layout change.